



TNS Hospitality

LAKE NDUTU LUXURY TENTED LODGE

“ I hope you have an experience that alters the course of your life,
because after Africa, nothing has ever been the same.”
— Susan Evans



TNS Hospitality
NDUTU LUXURY TENTED LODGE





W E L C O M E

- One's destination is never a place but a new way of seeing things -

Tanzania is certainly one of the most amazing destinations for safari lovers, offering the ultimate in locations with a unique blend of wildlife and nature.

At TNS Hospitality, we have a vision to provide the utmost in luxury and experience so our guests can take a memorable piece of Africa back with them.

Lake Ndutu Luxury Tented Lodge is located in the Ndutu area, which borders the Serengeti National Park.

We take this opportunity to welcome you, whether you are a returning guest or someone experiencing our hospitality for the first time.

- **Aida Diawara** -
Marketing Director





L O C A T I O N

Ndutu is located in close proximity to the Ngorongoro Conservation Area and towards the South Eastern part of the Serengeti.

The plains around Ndutu are the main holding grounds for the annual wildebeest migration, which is a renowned natural spectacle. From December to April, the wildebeests together with other migratory animals congregate and linger in the area in vast numbers before moving across the Serengeti in search of greener pastures and water.

The Ndutu area forms an important part of the Serengeti ecosystem as the short grass plains provide a natural habitat for the calving season. David Martin appropriately writes in his Ngorongoro guidebook, "This is their home pastureland, the only place of any protracted residence."

This process usually takes place between January through to March.

Ndutu is additionally famous for its resident game. This includes a number of lion prides, cheetahs, striped hyenas, elephants, leopards, genets, impalas, hartebeests, giraffes, dikdiks and zebras.

December – March: Migration arrives in Ndutu in search of food/water and for the calving season.

April: Migration moves to the central Serengeti with predators such as lions, cheetahs, jackals, leopards and hyenas following.





“ The continued existence of wildlife and wilderness is important to the quality of life of humans. ”
— Jim Fowler



“Take only memories, leave only footprints”
– Unknown



T H E L O D G E

Lake Ndutu Luxury Tented Lodge is located between the South Eastern Serengeti and the Ngorongoro Conservation Area in the Ndutu region.

It is a prime location to view the resident game in the area as well as the great migration. Additionally, it makes for an ideal stopover to the neighbouring Serengeti National Park.

The Lodge is beautifully designed with the major element of design ‘space’ in mind. It has twenty well-appointed permanent tent structures cleverly built on stilts offering a true African safari experience.

We offer a combination of standard double, twin, triple and family suites.

The lodge is built to blend in the natural environment dominated by acacia trees and thick bush shrub with a beautiful view of Lake Ndutu. All the natural vegetation is preserved and protected making sure the wildlife in the area is surrounded in its natural territory.

We believe in protecting the natural wonder around us therefore encourage eco-friendly living by utilising solar power to generate electricity and hot water.

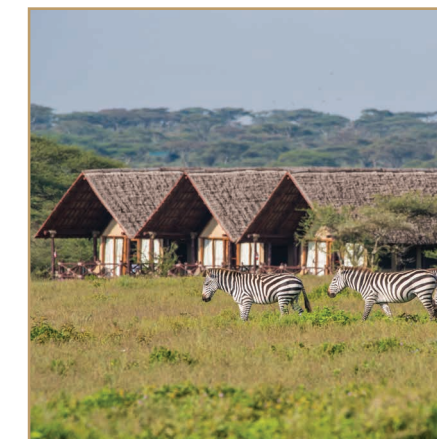
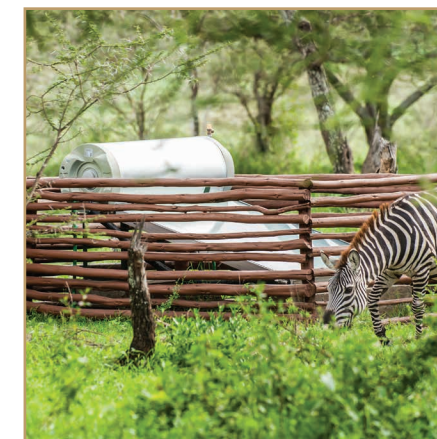

THE TENTS

The guest tents are about 70sqm resting on wooden stilts and a platform elevated a metre from the ground nestling under makuti roofs (palm fronds).

The airy rooms feature a large bedroom with wooden flooring and floor to ceiling glass panels affording our guests a breath-taking view of the scenery over the decked balcony. The interior is tastefully decorated using the African culture for true inspiration as the central theme in all tents.

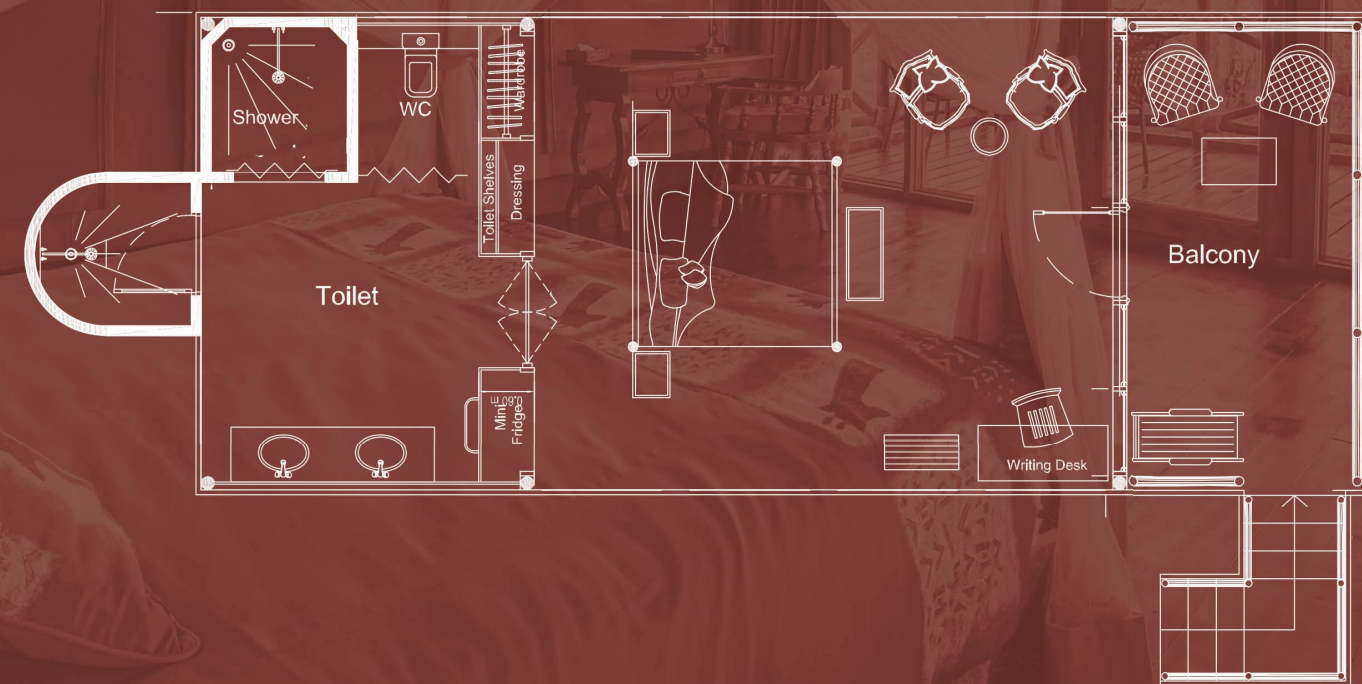

Room features:

- Hardwood beds with mosquito nets
- Writing desk, chair and desk lamp
- In room sofas with a coffee table
- Wardrobe
- Dressing area
- Hair dryer
- Safe deposit box
- Mini fridge
- Ceiling fan
- Luggage rack
- Mosquito spray & wipes
- Hot water
- 24 hours electricity
- Free Wi-Fi
- Private balcony with lounging furniture



F A M I L Y S U I T E S

The lodge boasts two sets of family suites especially designed to cater for families travelling with children and young adults or for a group of friends planning a stay together.

Each suite has three en-suite tented rooms interconnecting through a bridge-like deck sharing the same platform. Included is a ramp for the physically challenged to provide easy access and mobility.

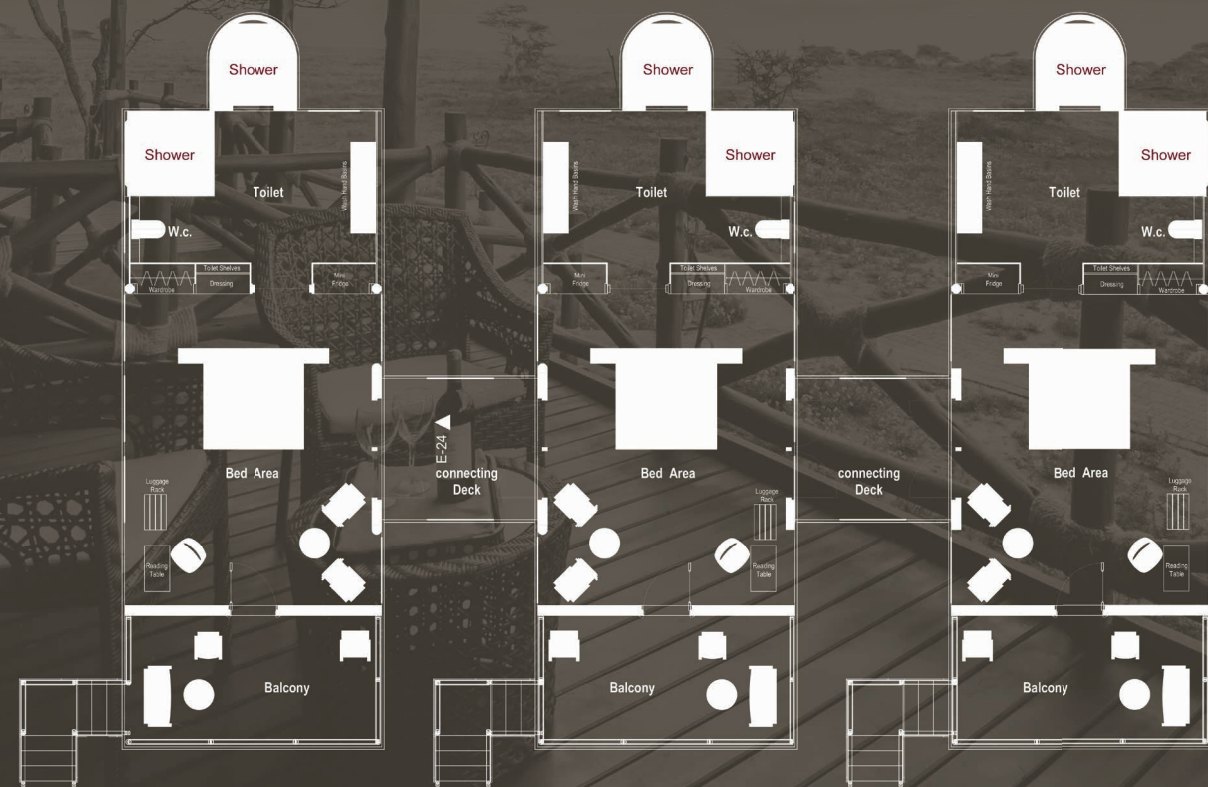

“ There are no strangers here... only friends you have not yet met. ”
– Unknown





T H E P O O L

The pool is located next to the bar and lounge area with a deck elevated about 2.2m above ground level to offer a clear view of the lake and Ndutu plains. It has an extended surface area of 3.5m wide all around which is covered in non-slip natural stone for safety.

Showers and changing room facilities are available below the pool deck for privacy.

Main Pool

Surface area: 105sqm - Shallow end: 0.9m - Deep end: 1.5m

Children's Pool

Surface area: 38sqm - Uniform depth: 0.9m



N D U T U D I N I N G

The in-house restaurant features a large wooden deck of its own overlooking views of the stunning African savannah.

One of the finest bush chefs and his team of waiting staff have a variety of cuisines on offer to cater for the diversity of guests visiting. These include continental with a blend of Chinese, Italian and Indian. We accommodate and welcome any special dietary requests.



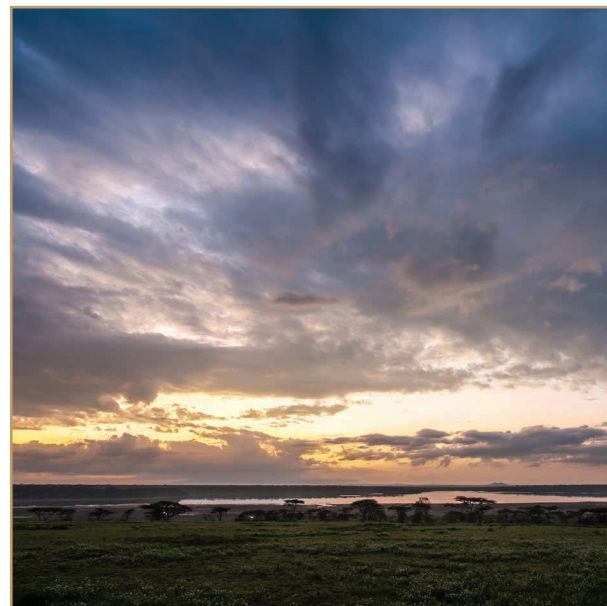

T H E L I O N ' S D E N

The Lion's Den Bar & Lounge is the perfect place to unwind and relax with a drink after an adventurous game drive session with spectacular lake views.



T H E M A S A I B O M A

The Masai Boma at the lodge is an exciting new feature introducing guests to the Masai way of life. Our chefs use the Boma to host social barbeque evenings with an array of foods to get the gastronomic juices flowing. The local Masai sometimes arrive and entertain the guests with the traditional Masai dance over a bonfire.

The Boma was built by commissioning the resident Masai people to promote and encourage a source of income for the local community. The Masai women have additionally enhanced the Boma by adding their creative art on the clay cladded walls.

A wide-angle photograph of a large herd of wildebeest standing on a lush green grassy plain. In the background, a calm body of water stretches across the middle ground, and beyond that, rolling hills covered in dense green forest rise under a clear sky. The wildebeest are dark brown with lighter-colored underbellies and distinctive curved horns. They are scattered across the foreground, some facing the camera and others looking away.

“ The earth has music for those who listen. ”
– George Santayana



Additional Facilities

- 24 hour reception/concierge
- Laundry service
- Curio shop for souvenirs
- Viewing Deck with a telescope
- Evening campfire
- Balloon safaris (on pre arrangement)
- Drivers and tour guide accommodation and meals



T H E A C T I V I T I E S



GAME DRIVES

Lake Ndutu region is famous for off road game drives allowing visitors a close up view of the wildlife unlike other parks where going off track is restricted. Highly qualified safari guides, who have vast knowledge on the wildlife and/or bird species and of course the area itself, undertake the drives.

Guests flying in to Ndutu can take advantage of our open top game drive safari car package, particularly popular for visitors who want to view the migration.

The safari vehicle is designed for optimum viewing to maximise photography opportunities with a high canvas roof for sun protection and six individual bucket seats arranged in a three-tier theatre style seating for unobstructed views.



WALKING SAFARI

The nature walk is usually pre arranged based on your safari schedule. It is a short walk around Ndutu where a guide and a park ranger accompany our guests. It is a great opportunity to learn about fascinating facts about wildlife, nature, birds, reptiles, insects and medicinal uses of plants.





SUNDOWNER

The serenity of a natural sunset with its contrasting array of colours is bound to leave you with an everlasting memory. The sundowner site offers uninterrupted views of the sunset under a huge umbrella of the acacia trees with a choice of drinks, dry snacks and canapés.



BUSH LUNCH/BREAKFAST

This is an exciting way to experience the beauty of Ndutu amidst a private bush meal with a chef overseeing live cooking in an environment that is carefully selected for its exclusive view points.



ROMANTIC DINNER

For all those special occasions, give us an opportunity to make it a remarkable recollection of reminiscence. Surprise that special person with a romantic candle lit dinner for two by our poolside overlooking Lake Ndutu and the breath-taking African savannah plains.



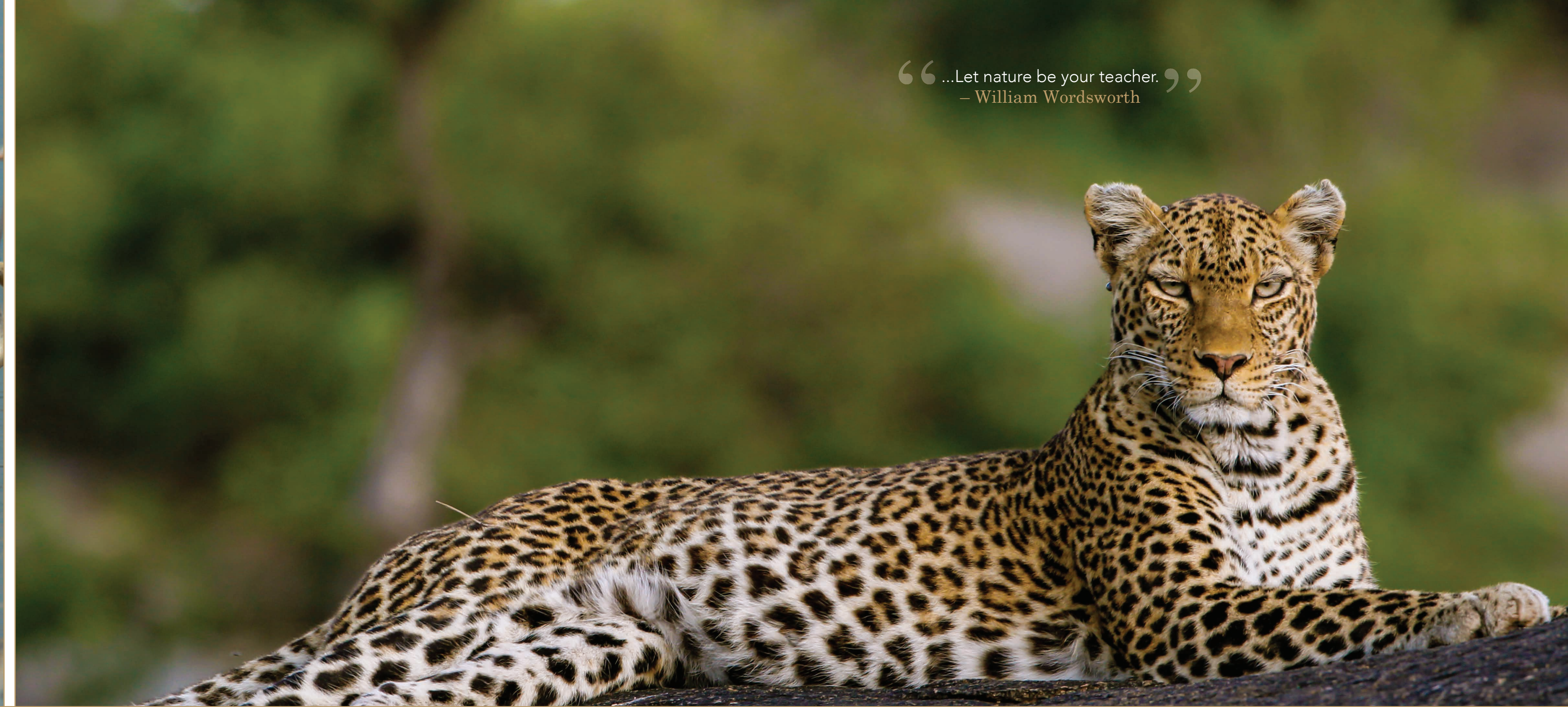



W H A T Y O U N E E D T O K N O W

- HEALTH REQUIREMENTS -

Due to Ndutu being a malaria and yellow fever zone, consider taking the appropriate vaccinations/inoculations. Please consult your doctor before travelling.

- LOCATION -

GPS coordinates: -2.9902917, 34.9803078
5km from the Ndutu airstrip (15 minutes drive)
90km from the Ngorongoro Crater (2 hours drive)
80km to Seronara in central Serengeti (1.5 hours drive)
150km from Lake Manyara National Park (3 hours drive)
50 minutes flight from Arusha 300km by car (5 hours drive)

- CLIMATE -

Wet season: November to May
Short rains: November to December
Long rains: March to May (green season with herds of wildebeests, zebras and gazelles seen in the area with calving taking place
January to March: opportunities to view predators such as lions, cheetahs and hyenas in action
June to October: dry season (quiet time of the year with less visitors but exclusive game viewing opportunities of the resident wildlife)
The lodge remains open all year through with discounted rates on offer between mid April and end of November

- POWER-

24 hours electricity is supplied by eco friendly solar power supported by two standby generators and inverters
Generators are switched on between 6am – 9am and 6pm to 9pm for hair dryers, shaving and for charging electronic devices
Voltage: 220W

- ACCOMMODATION -

20 large tents of about 70sqm
2 sets of family suites each with three interconnecting en-suite rooms
Tents for the physically challenged are available on request
Lounge and dining areas have wheelchair access
Tents are elevated a metre from the ground resting on wooden stilts and platforms and set about 15 metres from each other to respect privacy

- ROOM AMENITIES -

En-suite bathrooms: two wash hand basins, flush toilets, two showers (indoor and open air outdoor shower with hot & cold running water)
Double, twin, and triple beds with quality linen, mosquito nets and bedside tables with lamps
Sofa sets with a coffee table
Remote controlled ceiling fan
Mosquito sprays and wipes
Writing desk, chair and desk lamp
Wi-Fi for internet access
Dressing table, magnifying glass, bathrobes and a hair dryer
Mini fridge
Safe deposit box
Tea & Coffee facilities
Large balcony with lounging furniture
Luggage rack

- PUBLIC AREAS -

Reception with a seating area and two washrooms
Lion's Den lounge and Simba restaurant separated by a view deck, both with a large open air terrace
A view deck with a telescope
A souvenir shop
Internet access
Campfire area
Masai Boma
Swimming pool

- ACTIVITIES -

Game drives in open 4x4 safari vehicles
Guided nature walks
Bush lunch
Sundowner
Balloon safaris
Romantic Dinner for two by the poolside



W W W . T N S H O S P I T A L I T Y . C O . T Z

LAKE NDUTU LUXURY TENTED LODGE

📍 18 Alina Towers
Nelson Mandela Road
PO Box 10678
Arusha, Tanzania

☎ +255 (0) 784 872267
✉ info@tnshospitality.co.tz

